

**FOCUS**<sup>®</sup>

Atelier Dominique Imbert SAS  
34380 Viols le Fort  
tél. : 04 67 55 01 93  
Fax : 04 67 55 77 77

Technical notice n°1197

10/01/2014

## GRAPPUS



**FOCUS**<sup>®</sup>

## description

The Grappus is a self-supporting, closed, airtight wood stove.

**The combustion chamber** is attached to the supporting tube (5 screws):

- Three-layer steel hearth
- Interior walls of hearth lined with refractory materials:  
Side walls + roof: 20mm vermiculite – 750kg/m<sup>3</sup>  
Floor: 30mm refractory slab
- removable (no tools required) baffle plate in flue outlet (for easy chimney-sweeping)
- removable backflow baffle plate and ash pan
- post-combustion system
- flow of fresh air along the glass panel
- combustion air drawn from exterior or from the room
- detachable side door
- hexagon-socket heat-resistant handle
- weight: 112 kg

**The floor plate** is attached inside the base of the supporting tube using 4 M12 X 100 expansion screws (supplied with the fireplace).

**The supporting tube** serves both as the base and the flue, supporting the different parts of the fireplace (outlet Ø 219.1 mm).

Weight: 35 kg

**The wood rack**, incorporated into the fireplace, is attached to the supporting tube (2 flat-head screws).

Weight: 28 kg

Guaranteed efficiency with a minimum flue length of 4 m (interior plus exterior).

## performance

- heat output : 8 Kw
- efficiency : 78%
- CO at 13% of O<sub>2</sub> : 0.12%
- particle emission : <75 mg/Nm<sup>3</sup>

## dimensions

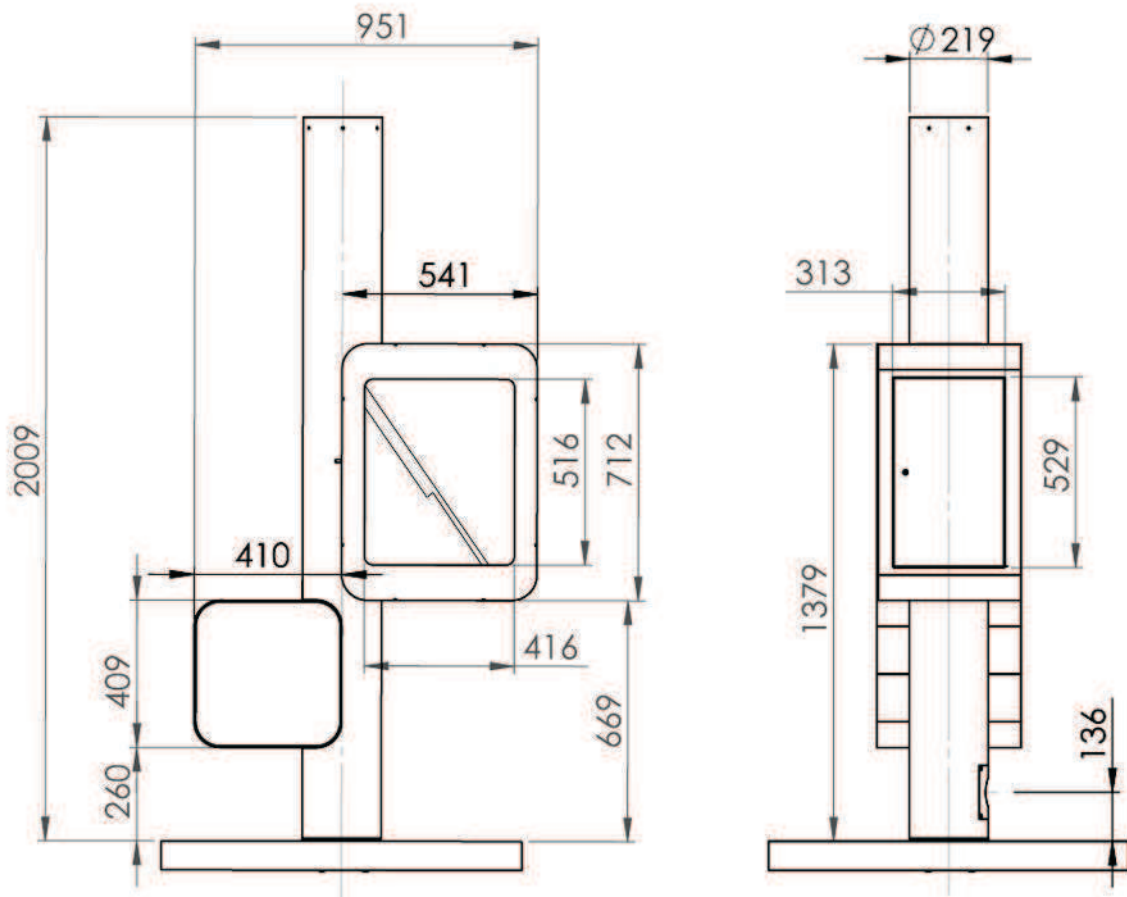

## assembled fireplace

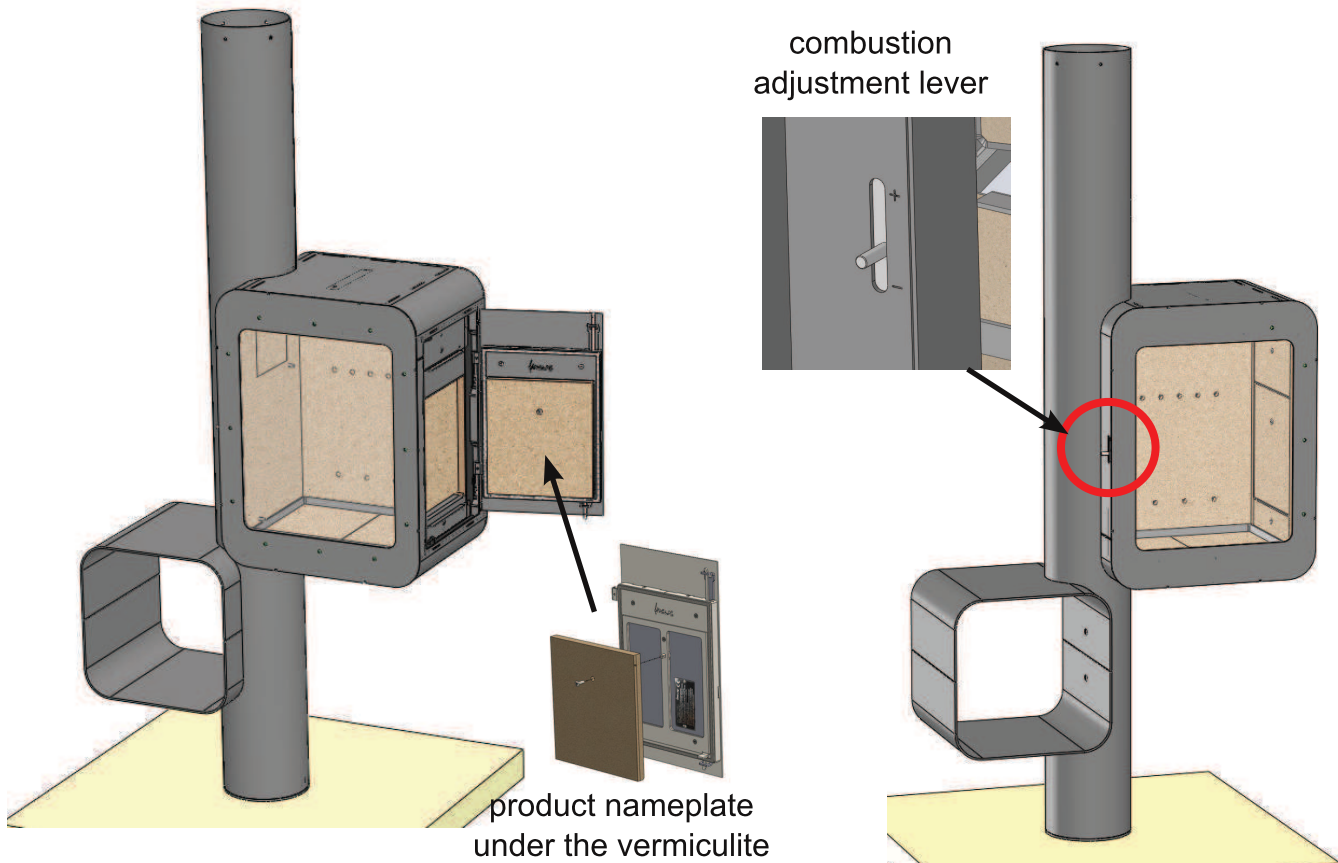

**assembly (as per assembly instructions)**

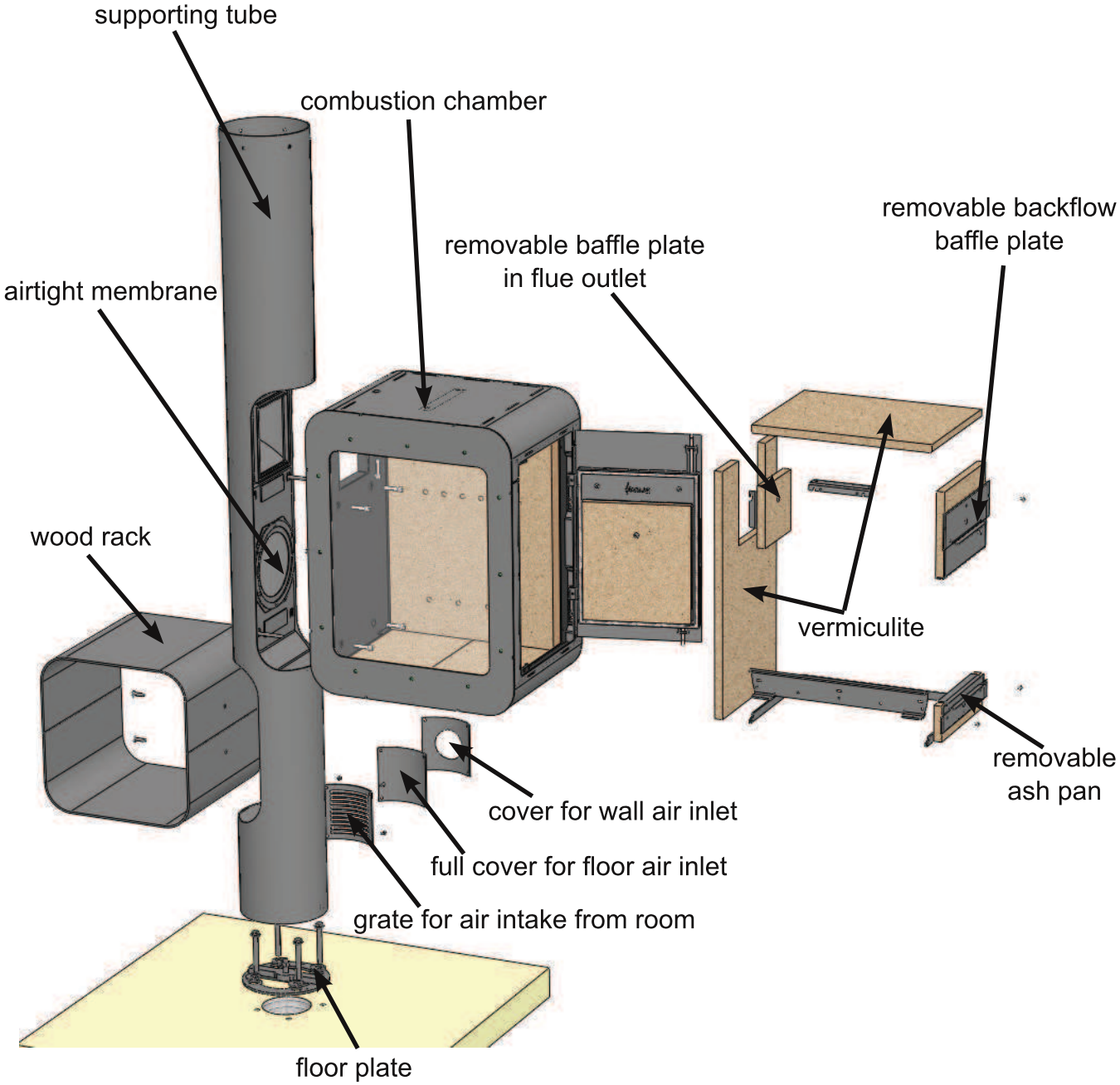

# air circulation

